

Securistyle Sterling

Heavy duty friction hinge

Suitable for:

PVCu



ALUMINIUM



TIMBER



The Securistyle Sterling friction hinge is suitable for many commercial applications on side or top hung windows.

It is manufactured from high grade austenitic stainless steel and is available in a variety of sizes. The Securistyle Sterling friction hinge gives superior window balancing and offers excellent weight carrying, particularly for curtain walling applications.

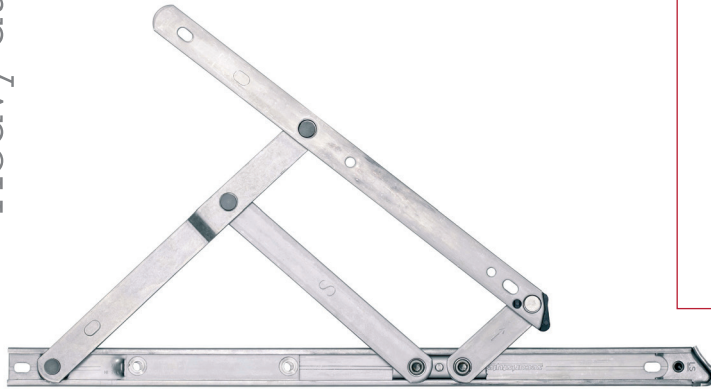

Features and Benefits

- Heavy duty hinge suitable for many commercial applications
- Adjustable and controlled friction for smooth operation
- Efficient locating system by means of a patented asymmetrical metal end cap
- Improved weather sealing and draught proofing performance
- Easy clean version available
- 16mm stack height
- Vector Excluder Security device available to improve security
- Made from austenitic stainless steel for high corrosion resistance

Sterling friction hinge

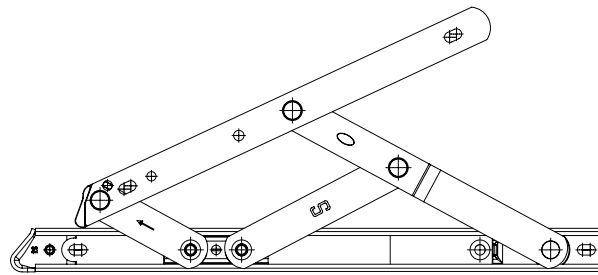

Sterling section details

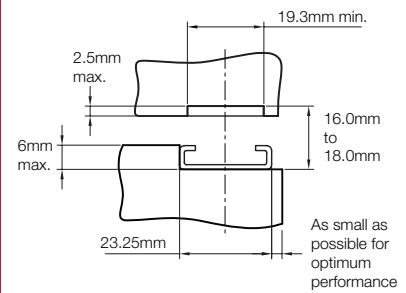

Sterling Top Hung	Hinge Size (mm)	Max Sash Weight (kg)	Max Sash Height (mm)	Min Sash Height (mm)	Opening Angle (+/-2.5°)
SPT10	262	40	640	267	50°
SPT12	313	50	800	640	50°
SPT16/W	415	65	1100	800	50°
SPTH16*	415	100	1100	600	30°
SPT22*	567	100	1500	1090	45°
SPT22W*	567	100	2000	1500	20°
SPT26*	680	180	2500	2000	20°

Sterling Side Hung	Hinge Size (mm)	Max Sash Weight (kg)	Max Sash Width (mm)	Min Sash Width (mm)	Opening Angle (+/-2.5°)
SPS10	262	38	660	300	85°
SPSH16	415	55	838	450	60°

*Vents of 100kg must be fitted with S7280 cam adjustment devices, which are optional on lighter vents.

Manufactured from

High grade 1.4301 stainless steel, components – nylon and acetal

Recommended screws

Stainless steel No.10 or equivalent

Performance

Tested in accordance with BS6375 pt2 BSEN1670 (Austenitic Grade 5)

More information

enquiries@titon.co.uk / 01206 713801